

# Everclear<sup>®</sup> Intercom

Mounting a single car master in a custom hall fixture

Typical mounting configuration requires 3.7" wide x 9.5" high x 1.4" deep.

Contact J. Fillips for any changes prior to using.

Side view

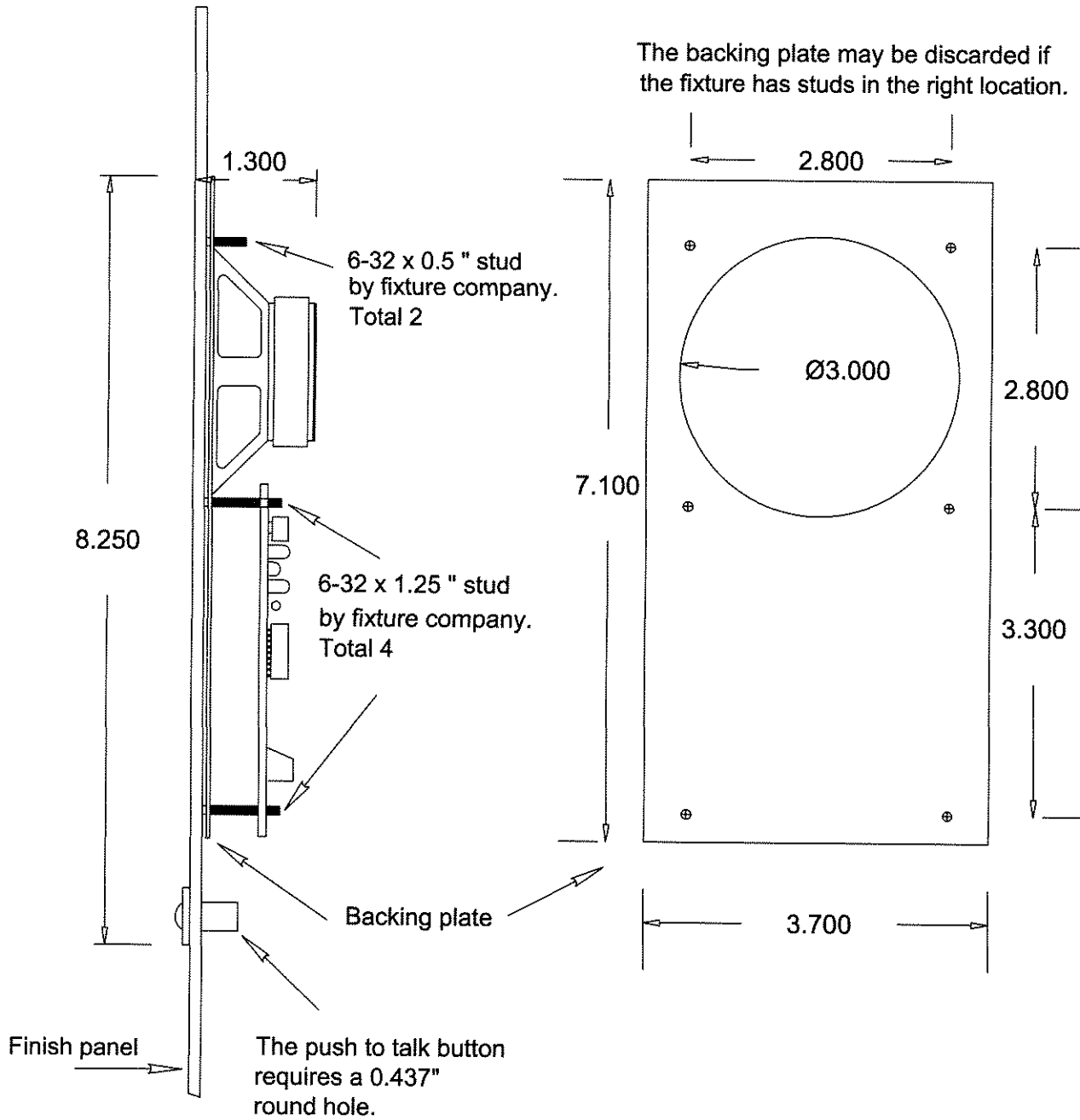

The on/off switch requires  
a rectangular hole  
0.506" wide x 0.765" high.

The on/off switch and push to talk button may be mounted  
any place except in front of the speaker or amplifier board.

# Everclear® Intercom

Mounting a single car master in a custom hall fixture - Alternate  
 Contact J. Fillips for any changes prior to using.

In a standard master station cover plate, the bottom 2 holes of the speaker fit on the same studs as the top 2 holes of the amplifier board. They may be mounted that way, on separate studs or with the amplifier behind the speaker.

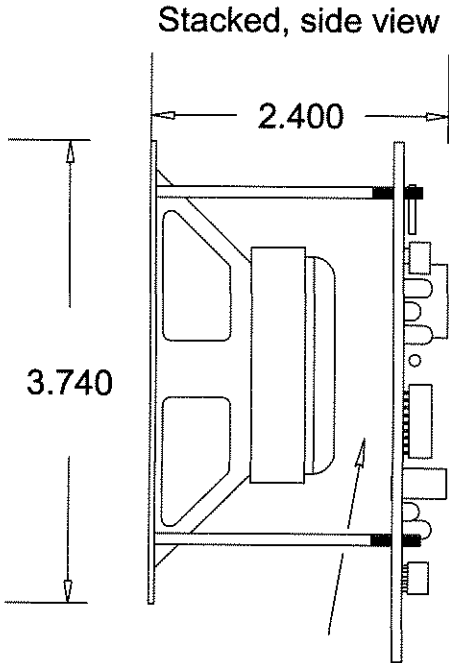

You must have no less than 1/2" between the speaker to the amplifier board.

Round hole for push to talk button.  
 Ø0.437



Rectangular hole for the on/off switch.  
 You may replace it with a round hole and switch of your choice.

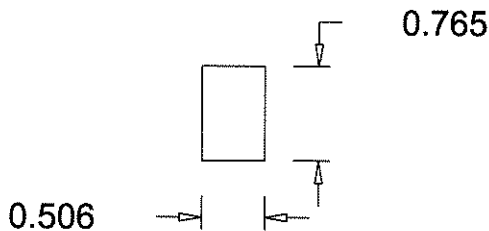

The on/off switch and push to talk button may be mounted any place except in front of the speaker or amplifier board.

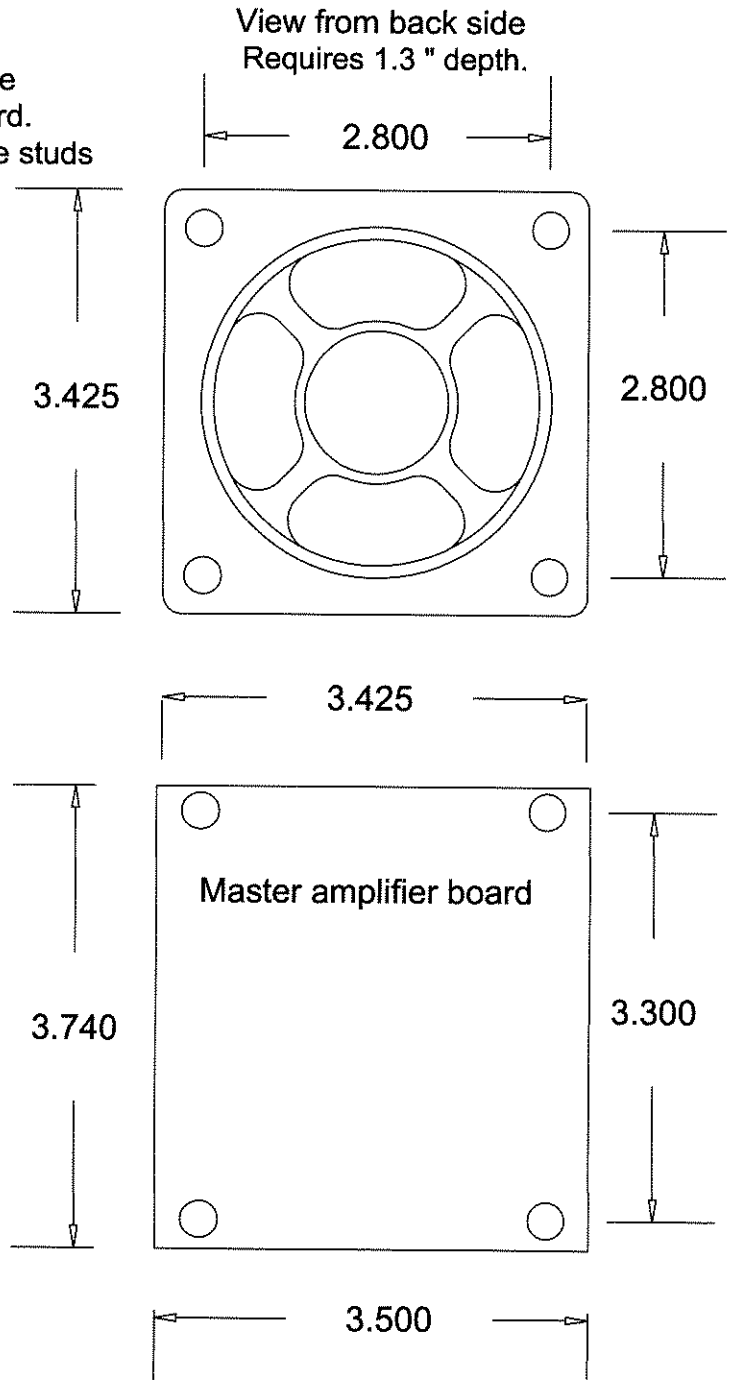

# Everclear® Intercom

**GRILL PATTERN FOR SPEAKER**  
 You may use a grill pattern of your choice or the one shown here.  
 Speaker cone is 3".

**ENGRAVING REQUIREMENTS**  
 Engrave adjacent to holes per drawing.  
 Use a type face and size dictated by elevator company's architect or consultant, and applicable code.  
 Factory installations use Arial or Helvetica bold, all caps, in sizes below:

0.200" high for ELEVATOR INTERCOM  
 0.150" high for PUSH TO TALK

**NOTE:** We provide a round Push to Talk button and a rectangular On/Off Switch.  
 The On/Off switch does not require engraving.

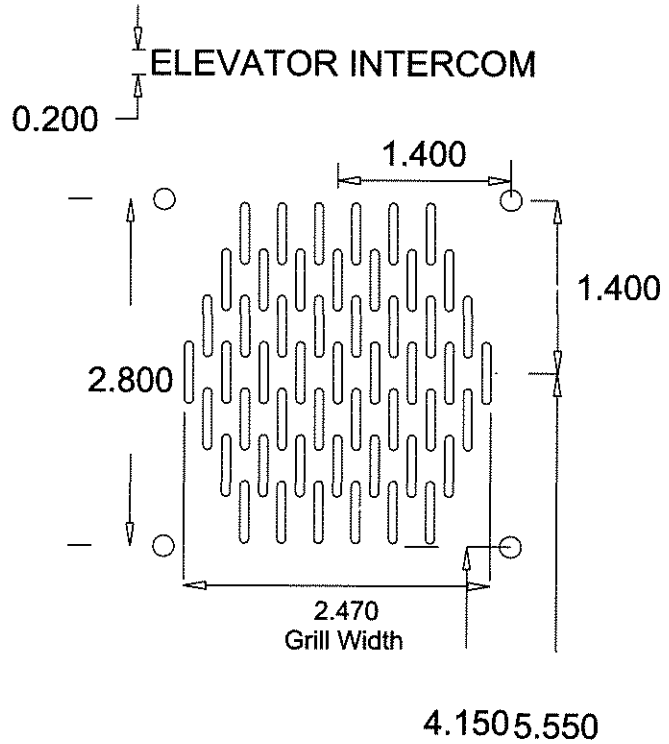

## WIRING

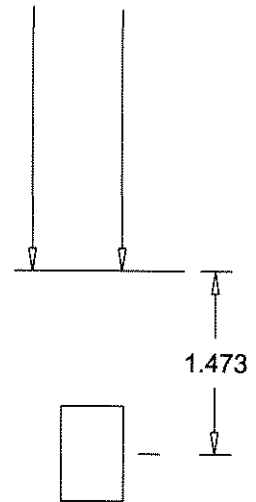
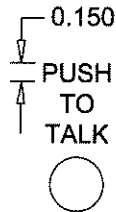
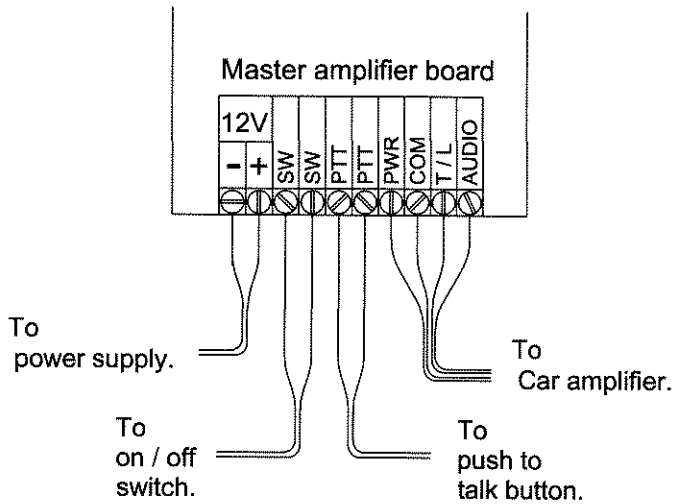

**JPhillips** LLC  
**Everclear® Intercom**

Single-car master mounting